

CONSTRUCTION SEQUENCE

- EXCAVATE FOR LEVEL BASE TO A LENGTH ADEQUATE FOR WIDTH OF THE REINFORCED MASS AND DRAINAGE SYSTEM AS REQUIRED BY SITE CONDITIONS AT BACK OF REINFORCED MASS.
- COMPACT FOUNDATION TO 95% STANDARD PROCTOR (ASTM D689).

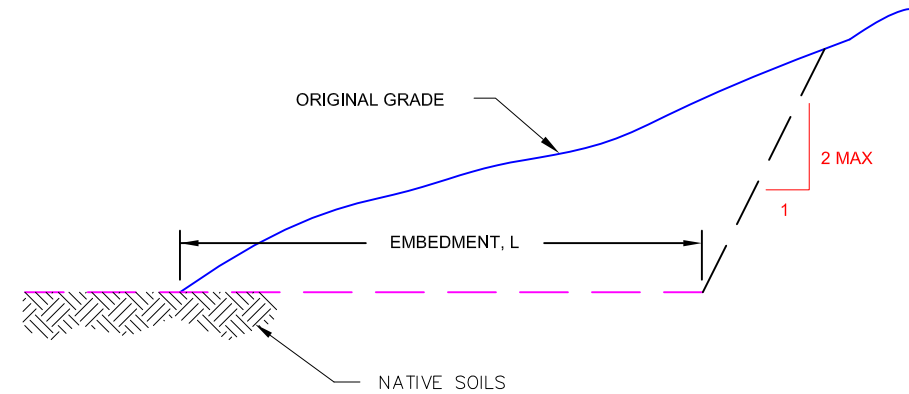

STEP 1

- CHECK LEVEL OF BASE.
- CHECK ALL LINE, GRADE, AND CURVES.
- PLACE FORM AT FRONT OF REINFORCED MASS AND LAY MIRAGRID XT SOIL REINFORCEMENT TO THE FACE OF THE FORM FORMWORK.
- PLACE MIRAFI 140N FACE WRAP AND DRAPE OVER THE FORMWORK TO THE SPECIFIED LENGTHS.
- PLACE BACKFILL IN MAXIMUM LIFTS OF 9 INCHES, AND COMPACT TO 95% OF STANDARD PROCOR.

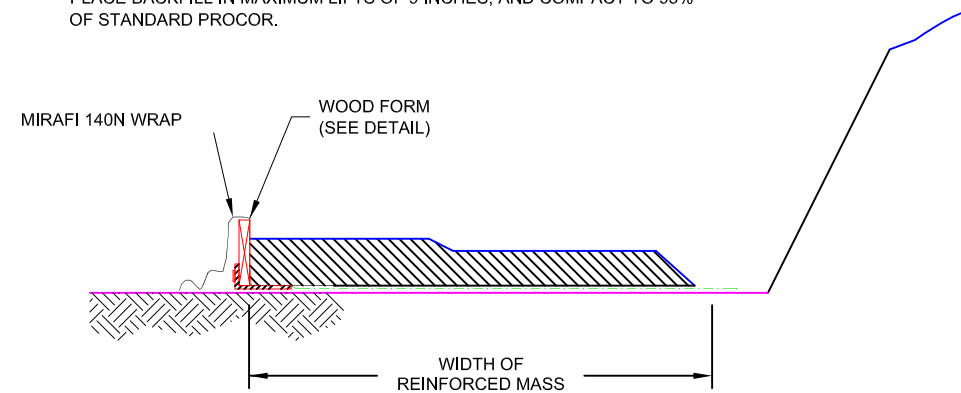

STEP 2

- WRAP MIRAFI 140N OVER COMPACTED FILL.
- PLACE FILL ABOVE UPPER SOIL WRAP PORTION AND LEVEL.
- REPEAT ABOVE STEPS UNTIL ADDITIONAL PRIMARY REINFORCEMENT IS REQUIRED.

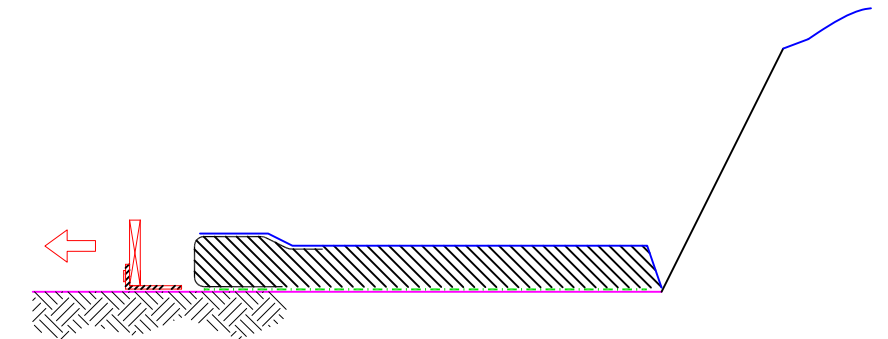

STEP 3

- INSTALL FIRST LAYER OF TENCATE MIRAGRID XT GEOSYNTHETIC REINFORCEMENT WITH ROLL DIRECTION PERPENDICULAR TO WALL FACE.
- PULL GEOSYNTHETIC TIGHT, KEEP TENSION APPLIED UNTIL BACKFILL IS PLACED, STAPLES OR STAKES MAY BE USED TO MAINTAIN TENSION.

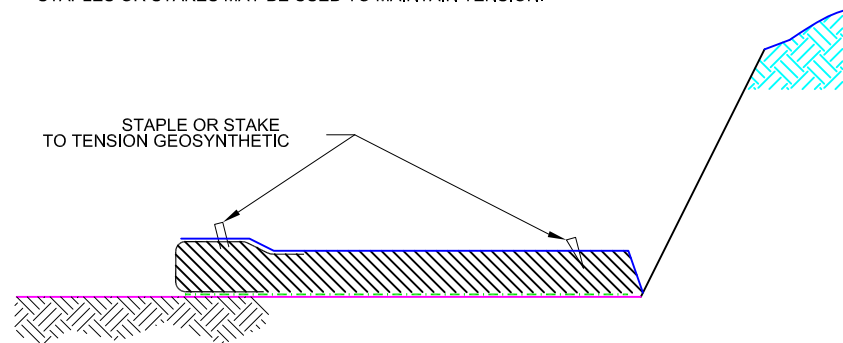

STEP 4

- PLACE NEXT COURSE REPEATING STEPS 2 AND 3.
- ADDITIONAL GEOSYNTHETIC REINFORCEMENT BY REPEATING STEPS 4.
- (SEE PLAN & PROFILE DRAWINGS FOR ELEVATIONS AND EMBEDMENT LENGTHS)

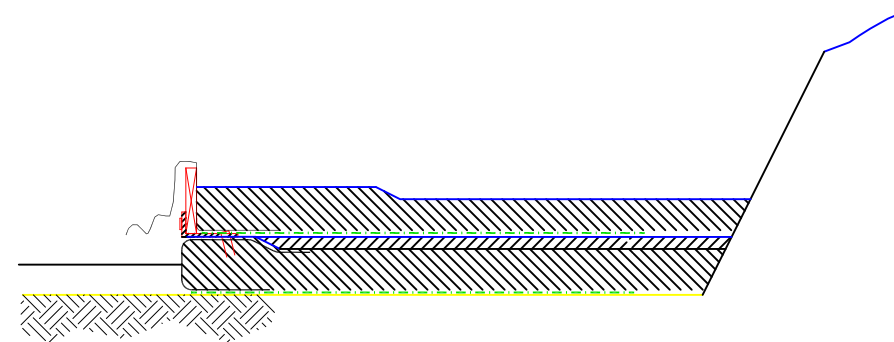

STEP 5

- REPEAT STEPS 2 THRU 4 UNTIL SLOPE IS AT REQUIRED HEIGHT.
- PLACE FINAL BACKFILL AND TOPSOIL .

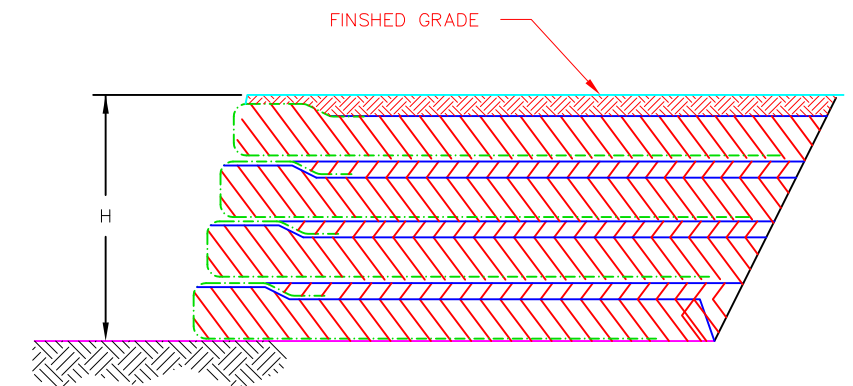

STEP 6

TENCATE
GEOSYNTHETICS
 365 SOUTH HOLLAND DRIVE
 PENDERGRASS, GA 30567
 TEL: (706) 693-1726 FAX: (706) 693-4400
 WWW.MIRAFI.COM

NOTE: THE STANDARD DETAILS ILLUSTRATED IN THESE DRAWINGS ARE FOR INFORMATION AND EVALUATION PURPOSES ONLY AND ARE NOT FOR CONSTRUCTION. PROJECT SPECIFIC CALCULATIONS, SHOP DRAWINGS AND SPECIFICATIONS, SIGNED AND SEALED BY A LICENSED STATE ENGINEER, ARE REQUIRED FOR CONSTRUCTION.

REINFORCED STEEP SLOPES (RSS) STANDARD DESIGN DETAILS

PROJ. NO:	REVIEWED BY:
DATE:	DRAWN BY:

REVISION DATES (SEE SHEET W1 FOR REVISION HISTORY):				

INSTALLATION	SHEET	OF
	1	1